

LANDSCAPING
 2- 8' LARGE EVERGREENS
 1 - 4' SMALL EVERGREEN
 NATIVE GRASS SEED AREA

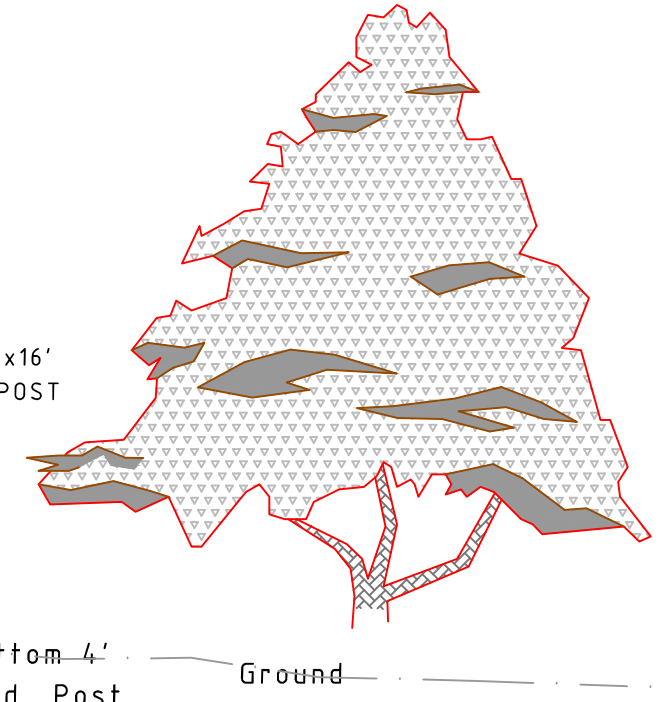
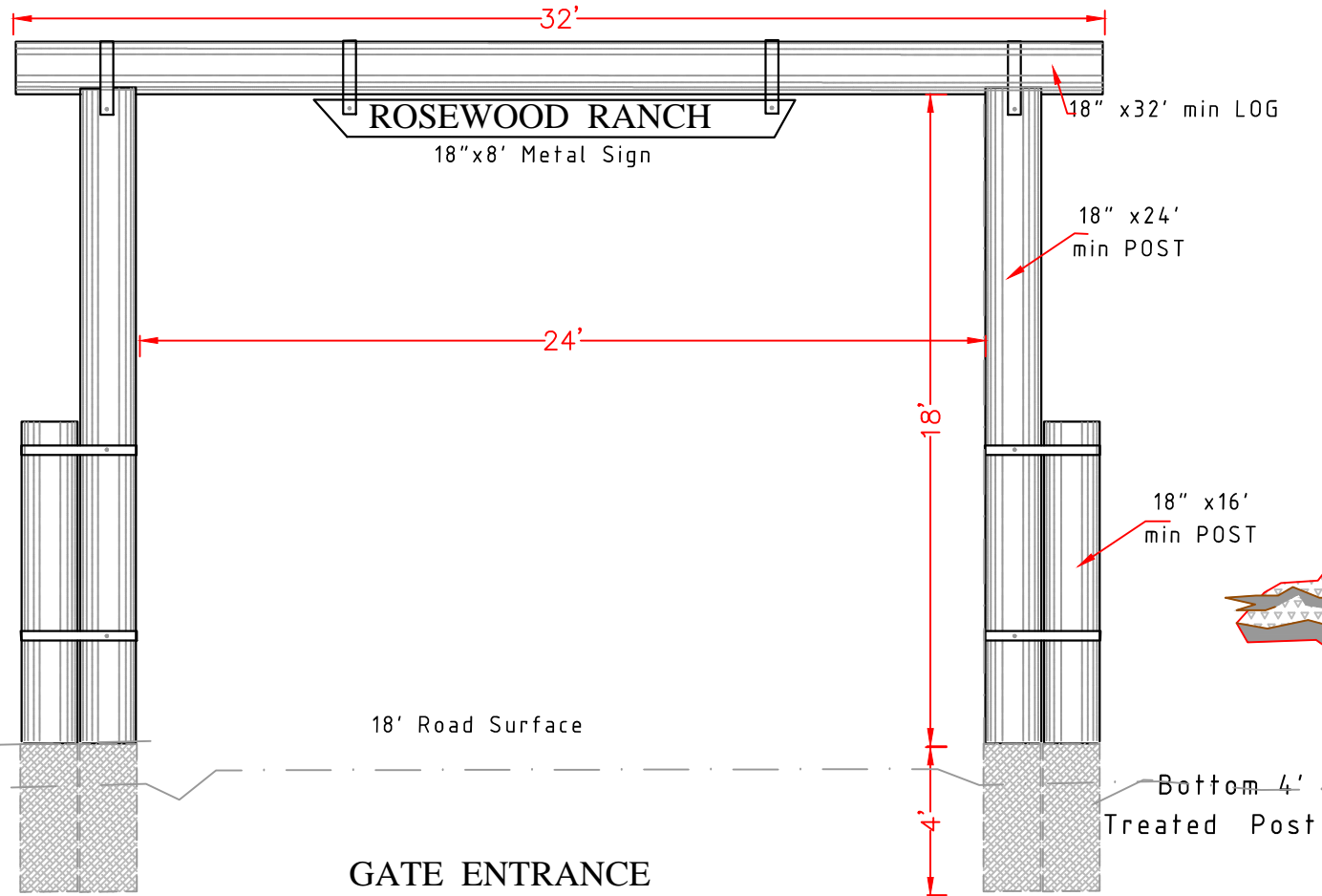
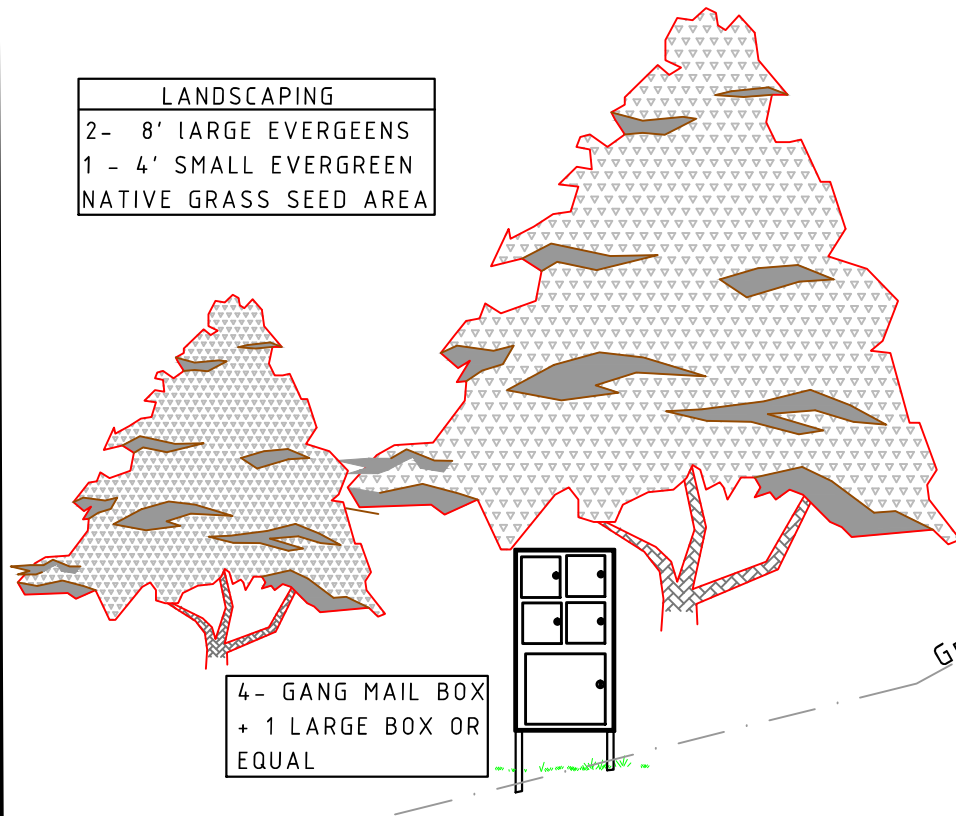

Subdivision Quantities

1-	Electric Power	Lin Ft	1800
2-	Telephone conduit	Lin Ft	1800
3-	Road Subgrade Exc	Cu Yds	550
4-	Base Gravel	Cu Yds	820
5-	¾" Surface Gravel	Cu Yds	250
6-	Common Lot Entrance	Sum	1
7-	Landscape Entrance	Sum	1 Each
8-	Fire Pond Exc, Grade	Sq ft	45,000
9-	Fire Pond Liner 50 mil	Sq ft	50,000
10-	Fire Pond Creek Weirs	Each	2
11-	Culverts 18"	Lin Ft	90

Subdivision Plans Index

- A-1 Landscape /Quantities
- R-1 Road & Utility Plans Layout
- R-2 Road Plan & Profile Rosewood Lane
- R-3 Road Plan & Profile Hotel Lane
- R-4 Road Typical Cross Section etc
- F-1 Fire System Plan
- F-2 Pond Details
- F-2 Fire Pond Enlargement

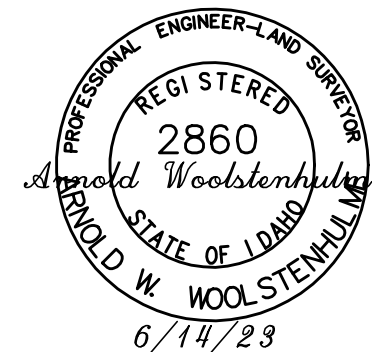

GATE, LANDSCAPING, SIGN ROSEWOOD RANCH

MOST OF THE NE 1/4 SECTION 31, TWP.6N., RNG. 45E.,
B.M., TETON COUNTY, IDAHO

CLIENT:
 SOLIMAR LLC
 1795 W Broadway PMB 29
 Idaho Falls, Idaho
 83402



255 South Main P.B.139
 Victor Id. 83455
 208-787-2952 aweng@ida.net

REV: AWW 6/14/2023

SURVEY: CLC 5/21
 PROJ: 20-267.TXT

DWG: AWW
 6/26/21

PROJ #21-02

Page: T-1 of 1